

BRETT STREET

Ø375

PSM 12345  
RL 18.352 A.H.D. (Der.)

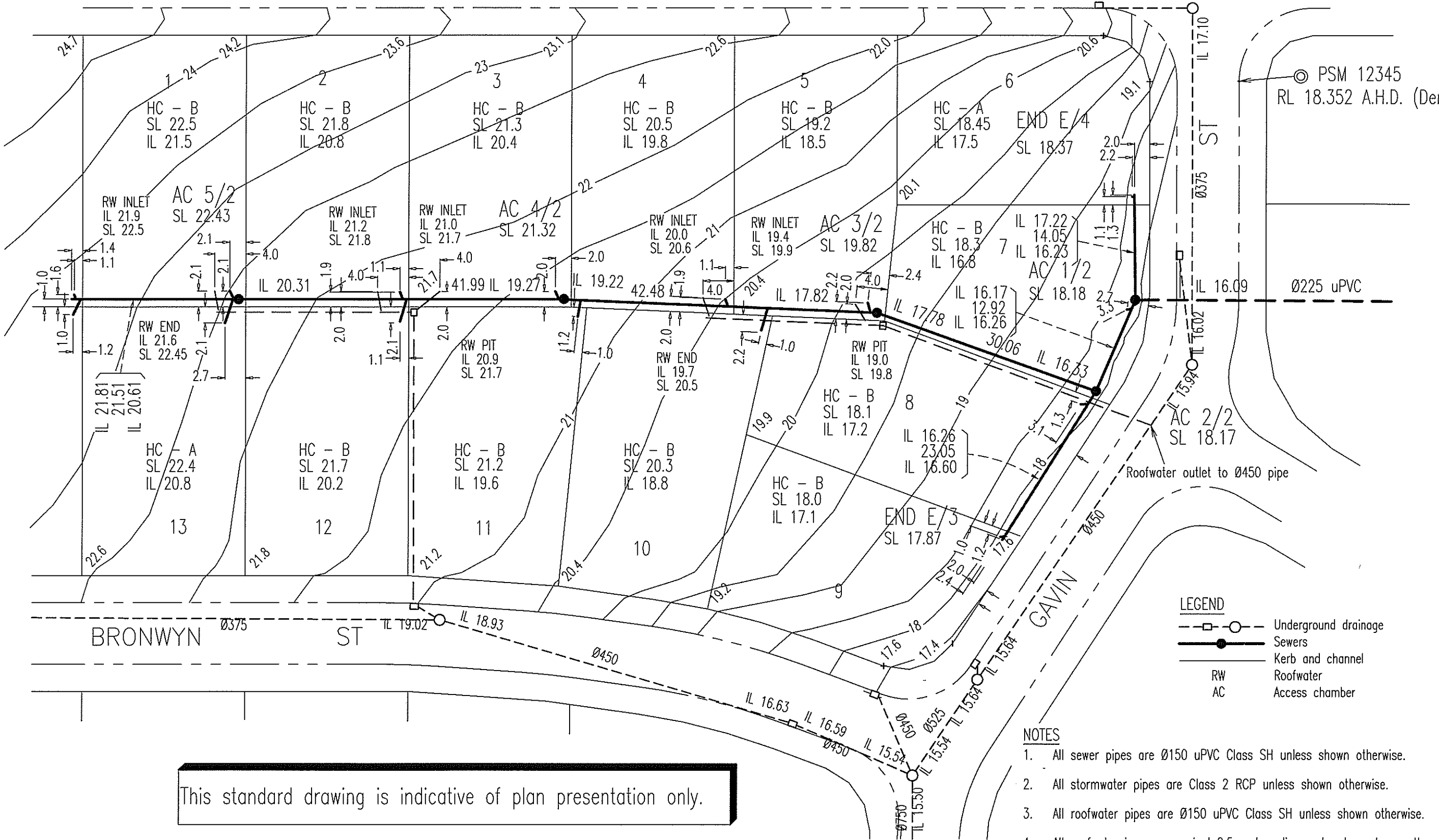

**LEGEND**

- Underground drainage
- Sewers
- Kerb and channel
- RW Roofwater
- AC Access chamber

- NOTES**
1. All sewer pipes are Ø150 uPVC Class SH unless shown otherwise.
  2. All stormwater pipes are Class 2 RCP unless shown otherwise.
  3. All roofwater pipes are Ø150 uPVC Class SH unless shown otherwise.
  4. All roofwater is on a nominal 0.5 metre alignment unless shown otherwise.

This standard drawing is indicative of plan presentation only.

A	ORIGINAL ISSUE	8/12/95
	REVISIONS	DATE

© INSTITUTE OF PUBLIC WORKS ENGINEERING AUSTRALIA QUEENSLAND DIVISION INC. -1995  
**DISCLAIMER.** The authors and sponsoring organisations shall have no liability or responsibility to the user or any other person or entity with respect to any liability, loss or damage caused or alleged to be caused, directly or indirectly, by the adoption and use of these Standard Drawings including, but not limited to, any interruption of service, loss of business or anticipatory profits, or consequential damages resulting from the use of these Standard Drawings. Persons must not rely on these Standard Drawings as the equivalent of, or a substitute for, project-specific design and assessment by an appropriately qualified professional.

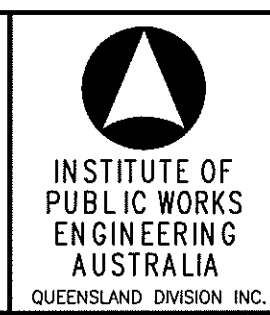

**SAMPLE AS CONSTRUCTED PLAN**

**SEWERAGE**  
**Standard**  
**Drawing**  
**S-0010**